

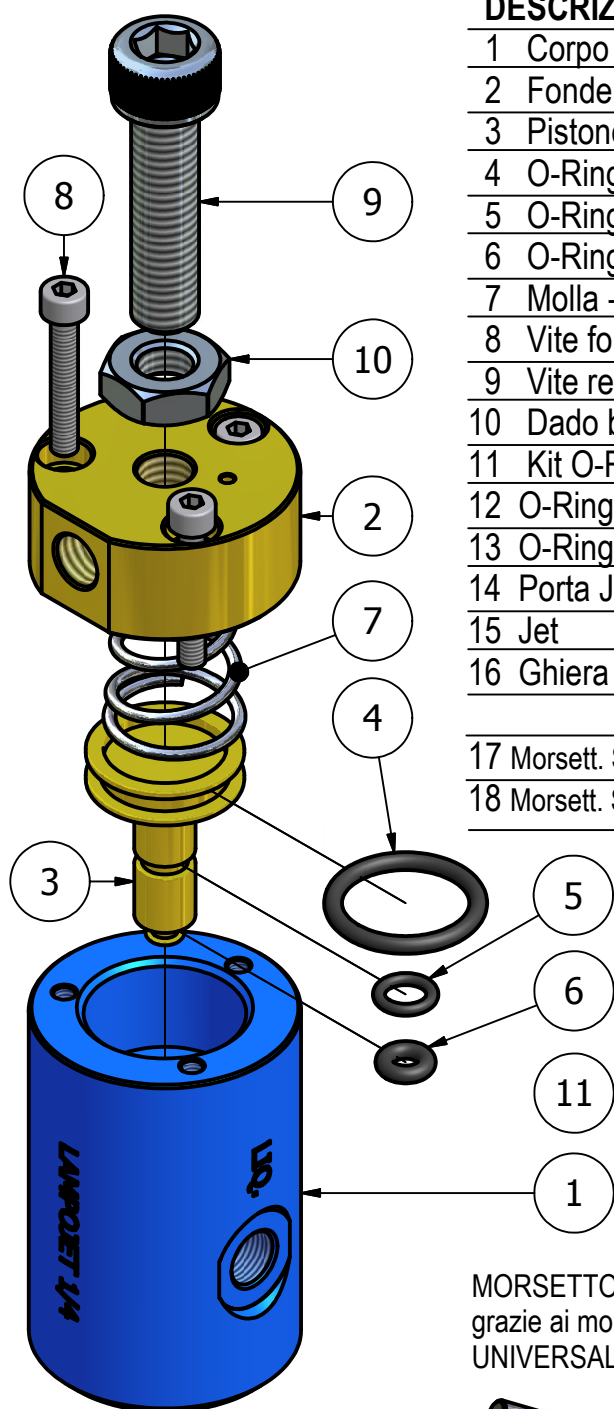

MOD. LAMPOJET 1/4



DESCRIZIONE DESCRIPTION	COD.
1 Corpo - Body	B-COR0004
2 Fondello - End cap	B-XFS0006
3 Pistone - Piston (4-5-6-inclusi-enclused)	B-XPI0005
4 O-Ring 18,72x2,62 (3075)	B-OR0019
5 O-Ring 6,07x1,78 (2025)	B-OR0015
6 O-Ring 3,63x2,62 - 90 SHORE A	B-OR0027
7 Molla - Spring	B-MOL0004
8 Vite fondello - End cap screw (M4x20) (x3)	B-VIT0028
9 Vite reg.liquido-Liquid setting screw	B-VIT0041
10 Dado bloccaggio - Lock nut	B-DAD0004
11 Kit O-Rings	B-XKI0019
12 O-Ring 13,1 x2,62 (117)	B-OR0002
13 O-Ring 11,11x1,78 (114)	B-OR0017
14 Porta Jet - Nozzle soaked	B-XPJ0002
15 Jet	B-XJE.....
16 Ghiera porta Jet - Jet cap nut	B-GHI0002
OPTIONAL:	
17 Morsett. Staff.+Bracci Ø10 - Universal Mount B.Ø10x150	B-XMS0003
18 Morsett. Staff.+Bracci Ø15 - Universal Mount B.Ø15x230	B-XMS0004

Pressioni di utilizzo-Working pressure:
Air-Liq. : min.4 max 8 bar

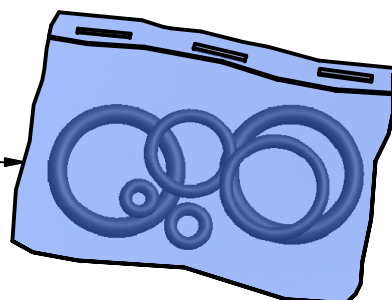

MORSETTO STAFFAGGIO + BRACCI : Direzioneabili in qualsiasi posizione grazie ai morsetti + bracci universali
UNIVERSAL MOUNT BRACKET: Adjustable thru any angle

